

# GT SERIES POWER UNITS

# STANLEY

®



The **GT Series** of Stanley Hydraulic Power Units are designed for continuous duty operation with an efficient oil cooler as standard equipment. With three different models to offer the underwater industry, Stanley Hydraulic Tools has a solid reputation of superior power units for top side work. The GTR unit provides 5 or 10 gpm, the GT18: 5 or 8 gpm and the GT23: 8 or 12 gpm – all @ 2000 psi.

## FEATURES

- Meets or exceeds HTMA hydraulic circuit design with superior cooling
- Electronically controlled engine speed – provides set flow
- Auto idle feature – lower fuel consumption and less noise
- Tool circuit lockout during engine startup – safety feature
- Quartz hour meter on control panel – records engine run time
- Lift & Latch handle with fold-up side handles
- 35-AH sealed, non-spillable, no maintenance battery located in covered compartment
- Electric start engine has pressure lubrication system, low engine oil shut down & spin on oil filter
- In tank hydraulic filter with dipstick and easy access filter replacement



## SPECIFICATIONS

	GT18	GTR10	GT23
<b>Output Capacity</b>	5 or 8 gpm / 20 or 30 lpm	5 or 10 gpm / 20 or 38 lpm	8 or 12 gpm / 30 or 45 lpm
<b>Pressure</b>	2,000 psi / 140 bar	2,000 psi / 140 bar	2,000 psi / 140 bar
<b>Circuit Type</b>	Open Center	Open Center	Open Center
<b>Hydraulic Reservoir Capacity</b>	3 gallons / 11 liters	3 gallons / 11 liters	3 gallons / 11 liters
<b>Couplers</b>	HTMA Flush Face	HTMA Flush Face	HTMA Flush Face
<b>Fuel Tank Capacity</b>	7 gallons / 26½ liters	7 gallons / 26½ liters	7 gallons / 26½ liters
<b>Engine</b>	Briggs & Stratton 18 HP Vanguard OHV, Gas	Briggs & Stratton 18 HP Vanguard OHV, Gas	Briggs & Stratton 23 HP Vanguard OHV, Gas
<b>Weight</b>	330 lbs / 150 kg	330 lbs / 150 kg	340 lbs / 154 kg
<b>Length</b>	35" / 89 cm	35" / 89 cm	35" / 89 cm
<b>Width</b>	21½" / 54.6 cm	21½" / 54.6 cm	21½" / 54.6 cm
<b>Height</b>	29" / 73.7 cm	29" / 73.7 cm	29" / 73.7 cm
<b>Heat Rejection</b>	5 HP	5 HP	5 HP

# GT SERIES POWER UNITS

# STANLEY

## ORDERING INFORMATION

### PART NUMBER

<b>GT18B01</b>	Single Circuit 5 or 8 gpm, Briggs & Stratton 18 HP, CE
<b>GT18B02</b>	Single Circuit 5 or 8 gpm, Briggs & Stratton 18 HP
<b>GTR10B02</b>	Single Circuit 5 or 10 gpm, Briggs & Stratton 18 HP
<b>GT23B02</b>	Single Circuit 8 or 12 gpm, Briggs & Stratton, 23 HP

### ACCESSORIES

<b>31848</b>	Dual Hose, 50' x 1/2", with couplers
<b>31972</b>	Dual Hose, 25' x 1/2", with couplers
<b>58633</b>	Twinned Hose, 25' x 1/2", with couplers
<b>58634</b>	Twinned Hose, 50' x 1/2", with couplers
<b>33212</b>	Weather Cover
<b>13360</b>	Hose Basket Conversion Kit
<b>64940</b>	12 VDC Male Plug, Marine Type
<b>64942</b>	12 V Receptacle Assembly

When hydraulic hose exceeds 100' (30.4 m) in length, increase I.D. of both pressure and return hose. For more information, consult Stanley Hydraulic Tools.

### IMPORTANT

To fill out a Product Warranty Recording form and for information on your warranty visit [stanleyhydraulic.com](http://stanleyhydraulic.com) and select the Warranty tab.

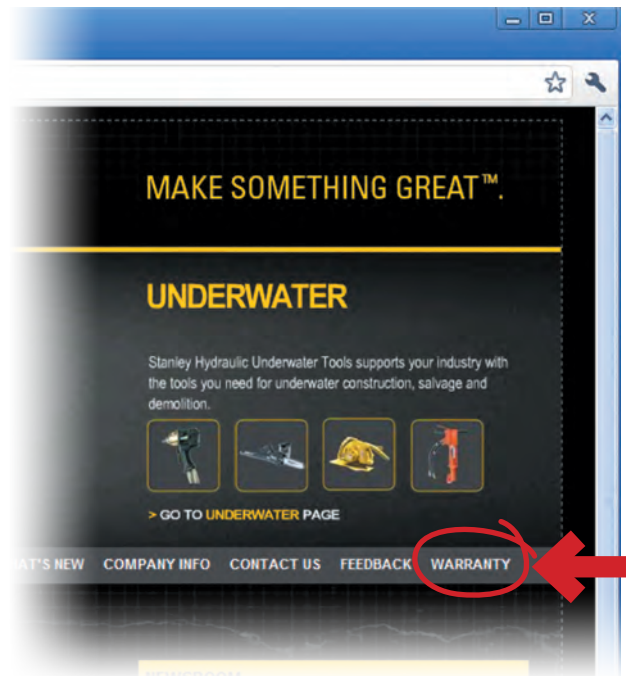

**Note:** The warranty recording form must be submitted to validate the warranty.

All Stanley Hydraulic Tools, parts, accessories and allied equipment are subject to design improvements, specifications and price changes at any time without notice and with no obligation to units already sold. Weights, dimensions and operating specifications listed herein are subject to change without notice. Where specifications are critical to your applications, please consult Stanley Hydraulic Tools.